

ULTIMATE EXTRA™

PROFILED PANEL SYSTEM



A

Galvanised and polyester powder coated RHS post

B

Full length channel clamp bar for invariable stepping

C

6mm wire diameter at close aperture for maximum security

D

SafeTFix hidden fixing system

Conforms to **BS1722: Part 14**

SafeTFix™

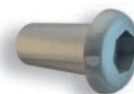

n55Plus

SafeTFix fixing system for added safety and security.

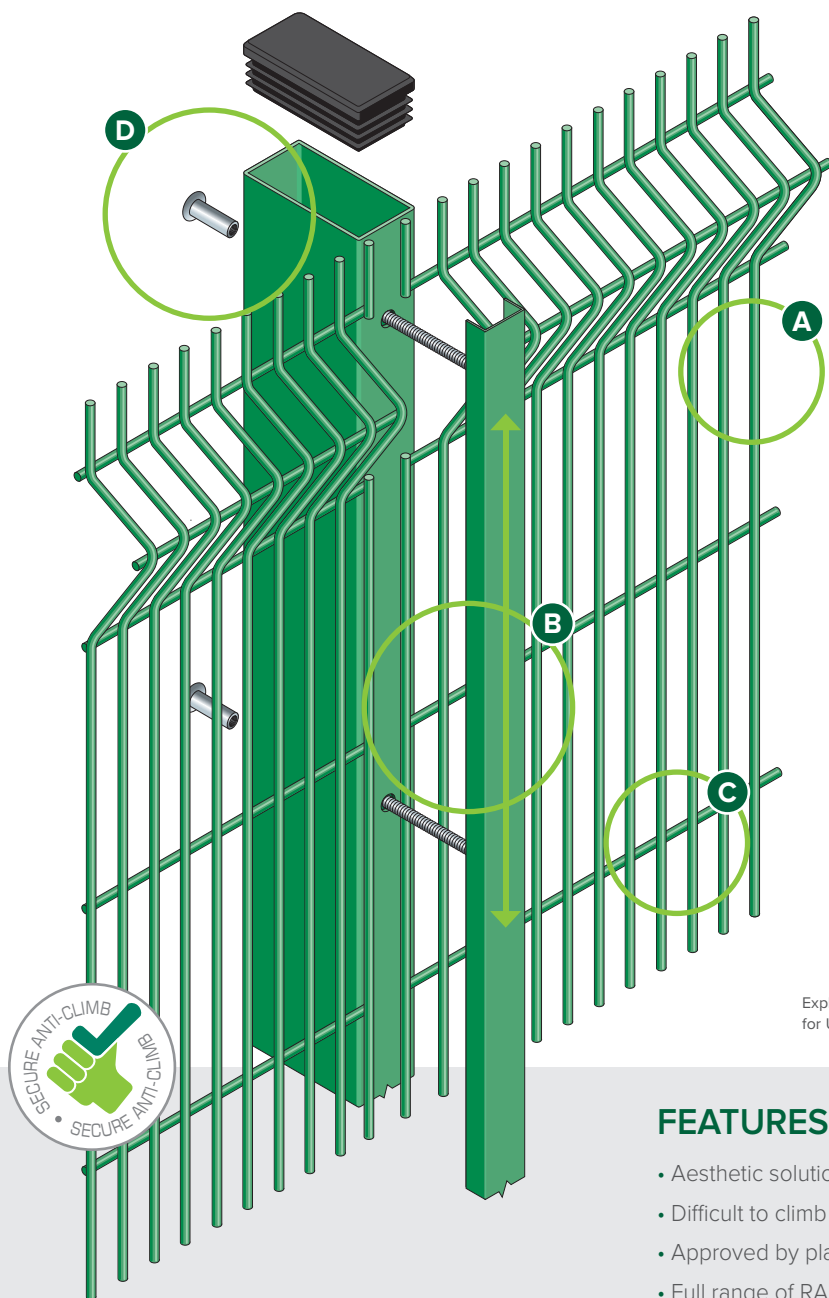

Exploded view of post and clamp for Ultimate Extra panel system



FEATURES

- Aesthetic solution
- Difficult to climb
- Approved by planning authorities
- Full range of RAL colours

SUITABLE FOR

- MOD
- Airports and seaports
- Police stations & secure units
- Power stations

SYSTEM DETAILS

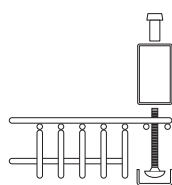

Plan of end

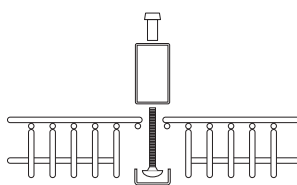

Plan of panels in line

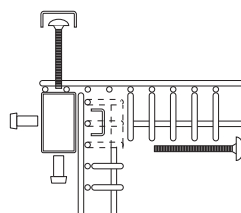

Plan of internal corner

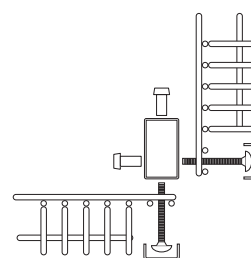

Plan of external corner

CALL 01270 764751 OR VISIT WWW.CLD-FENCING.COM



DESCRIPTION

Offering all the security features of the standard Ultimate™ profiled panel system - but with thicker and denser wire panels - Ultimate Extra™ provides even more protection as perimeter fencing for high-status premises including schools, seaports and airports.

The vertical 6mm heavy duty wire are just 25mm apart on each panel, providing great strength and proving extremely difficult to climb. Upper profiles enhance the strength of the fencing, along with a galvanised and polyester powder coated security post and clamp bar.

Specified across the United Kingdom by Councils and Security Consultants, the Ultimate Extra™ conforms to BS 1722-14 for open mesh steel panel fences. This popular choice also offers excellent visibility despite the close wire centres and regardless of the wide range of RAL colour you decide upon.

FINISH

Galvanised and polyester powder-coated, after stringent cleaning and treatment, to give a well adhered coating of 60 microns. RAL range of colours available.

PANEL DIMENSIONS

Heights	1800, 2030, 2430, 3030mm
Panel width	2475mm (up to 2430mm) 2050mm (3030mm)
Mesh size	165 x 25mm
Wire diameter	6mm
Triangular folds	3 or 4
Top edge projection	25mm†

† Can be inverted to give flush edge.

All dimensions are nominal

ULTIMATE EXTRA POSTS AND CLAMPS

For the Ultimate Extra profiled panel system, CLD offers a standard post and clamp system which provides a complete method of securing, allowing infinitely variable stepping of panels. It is versatile, strong, simple to fix and vandal resistant, yet allows panels to be removed without damage to either post or clamp. Accidentally damaged panels can be replaced without removing the post.

SLOPING GROUND

Panels can be stepped as required. Where gradients exceed 1:16, it is recommended that taller panels are either part-buried or additional posts are used.

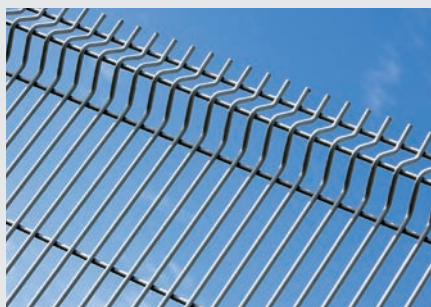

VARIATIONS

In addition to the standard posts many variations are available to accommodate site requirements:

- Alternative sections
- Wall fixing plates, cranked posts or base plated
- Cranked or straight extensions for barbed or razor wire
- Cranked panels



DIMENSIONS

Posts	80 x 40mm RHS
Clamping channels	41 x 21mm
Post centres	2485mm (up to 2430mm) 2060mm (3030mm)